



Bundoora Primary School

Yard Duty and Supervision

Date: August 2023



Help for non-English speakers.

If you need help to understand this policy, please contact the school office on 9467 2601

PURPOSE

To ensure school staff understand their supervision and yard duty responsibilities.

SCOPE

This policy applies to all teaching and non-teaching staff at Bundoora Primary School, including education support staff, casual relief teachers and visiting teachers.

POLICY

Appropriate supervision is an important strategy to monitor student behaviour and enables staff to identify and respond to possible risks at school as they arise. It also plays a vital role in helping schools to discharge their duty of care to students.

The Principal is responsible for ensuring that there is a well organised and responsive system of supervision and yard duty in place during school hours, before and after school, and on school excursions and camps and other school activities.

School staff are responsible for following reasonable and lawful instructions from the Principal, including instructions to provide supervision to students at specific dates, times, and places. Supervision should be undertaken in a way that identifies and mitigates risks to child safety.

Before and after school

Bundoora Primary School's grounds are supervised by school staff from 8:40 until 3:30 Outside of these hours, school staff will not be available to supervise students.

Before and after school, school staff will supervise the front and middle sections of the school and Breakfast club area of the Palace.

Parents and carers will be advised through regular reminders in our newsletter that they should not allow their children to attend Bundoora Primary School outside of these hours. Families will be encouraged to contact the school office on 03 9467 2601 or the TheirCare website for more information about the before and after school care facilities available to our school community.

If a student arrives at school before supervision commences at the beginning of the day, the Principal or nominee staff member will, as soon as practicable, follow up with the parent/carer to:

- advise of the supervision arrangements before school
- request that the parent/carer make alternate arrangements.

If a student is not collected before supervision finishes at the end of the day, the Principal or nominee staff member will consider whether it is appropriate to:

- attempt to contact the parents/carers.
- attempt to contact the emergency contacts.
- place the student in an out of school hours care program (if available and the parent consents)
- contact Victoria Police and/or Child Protection to arrange for the supervision, care, and protection of the student.

Yard duty

All staff at Bundoora Primary School are expected to assist with yard duty supervision and will be included in the term roster.

The Principal is responsible for preparing and communicating the yard duty roster on a regular basis. At Bundoora Primary School, school staff will be designated a specific yard duty area to supervise.

Yard duty areas.

The designated yard duty areas for our school as of August 2023 are:

Area	
Area 1	Gym/Hall
Area 2	Front playground up to area in front of OSHC
Area 3	Front, Mini Northland, basketball court behind the Palace (BER)
Area 4	Discovery Toilets and middle area of school
Area 5	Library

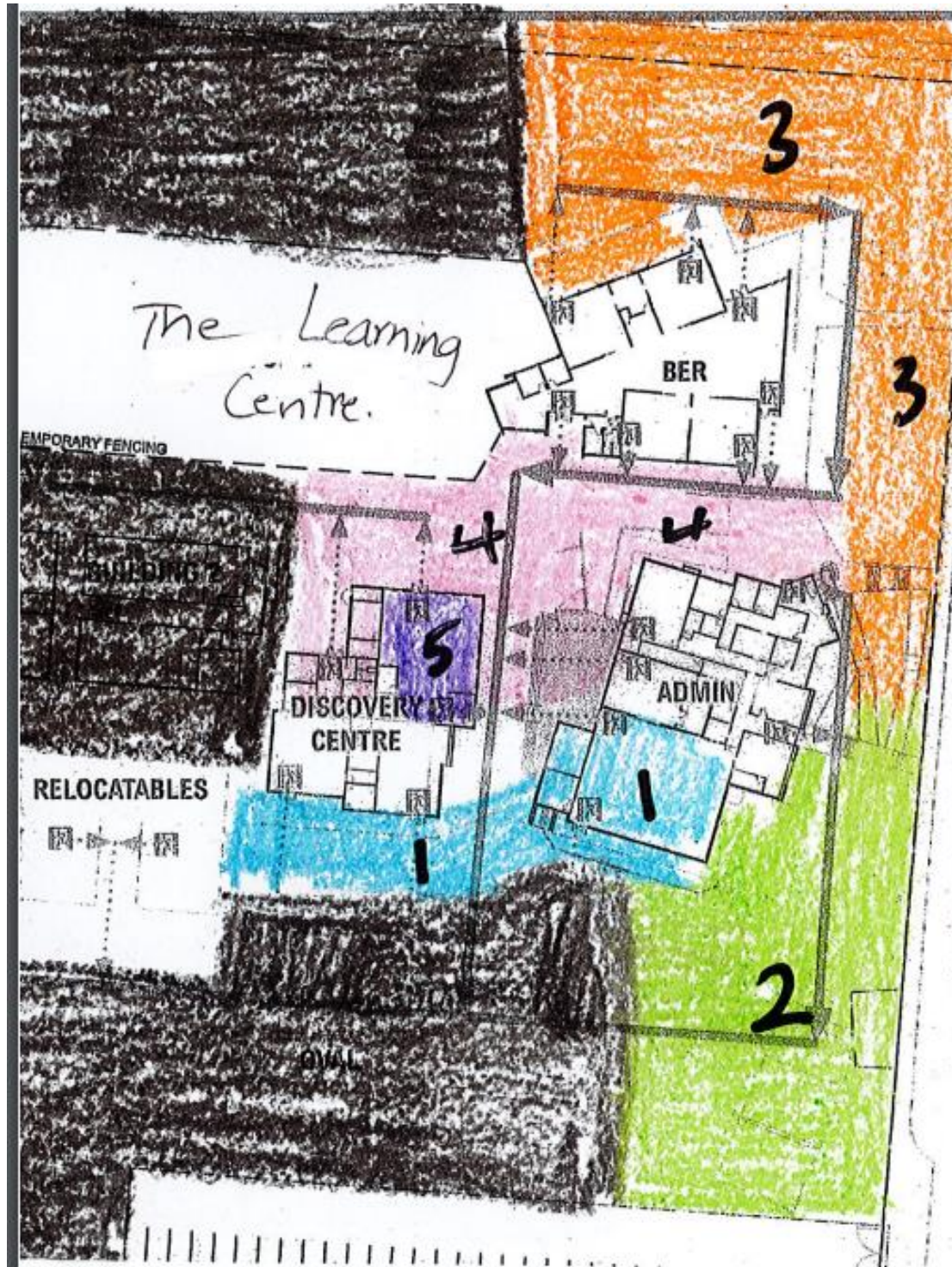

Yard duty equipment

School staff must:

- wear a provided safety/hi-vis vest whilst on yard duty. Safety/hi-vis vests will be provided for each staff member
- carry the yard duty first aid bag at all times during supervision. The yard duty first aid bag will be provided to each staff member

Yard duty responsibilities

Staff who are rostered for yard duty must remain in the designated area until they are replaced by a relieving staff member.

During yard duty, supervising school staff must:

- methodically move around the designated zone ensuring active supervision of all students
- where safe to do so, approach any unknown visitor who is observed on school grounds without a clear legitimate purpose, and ensure they have a visitor pass and have signed in
- be alert and vigilant
- intervene immediately if potentially dangerous or inappropriate behaviour is observed in the yard
- enforce behavioural standards and implement appropriate consequences for breaches of safety rules, in accordance with any relevant disciplinary measures set out in the school's Student Engagement policy
- ensure that students who require first aid assistance receive it as soon as practicable
- log any incidents or near misses as appropriate on Compass (Chronicles) and EduSafe Plus (as appropriate).

When being relieved of their yard duty shift by another staff member, the staff member must ensure that a brief, but adequate verbal 'handover' is given to the relieving staff member in relation to any issues which may have arisen during the first shift.

If the supervising staff member is unable to conduct yard duty at the designated time, they should contact the Assistant Principal with as much notice as possible prior to the relevant yard duty shift if a yard duty swap cannot be made the staff member concerned.

If the supervising staff member needs to leave yard duty during the allocated time, they should contact the Assistant Principal but should not leave the designated area until the relieving staff member has arrived in the designated area.

If the relieving staff member does not arrive for yard duty, the staff member currently on duty should send a message to the office or call the Assistant Principal and not leave the designated area until a relieving staff member has arrived.

Students will be encouraged to speak to the supervising yard duty staff member if they require assistance during recess or lunchtime.

Classroom

The classroom teacher is responsible for the supervision of all students in their care during class.

If a teacher needs to leave the classroom unattended at any time during a lesson, they should first contact their team partner for assistance. The teacher should then wait until a replacement staff member has arrived at the classroom before leaving.

School activities, camps and excursions

The principal and leadership team are responsible for ensuring that students are appropriately supervised during all school activities, camps and excursions, including when external providers are engaged to conduct part or all of the activity. Appropriate supervision will be planned for school activities, camps and excursions on an individual basis, depending on the activities to be undertaken

and the level of potential risk involved, and will follow the supervision requirements in the Department of Education and Training [Excursions Policy](#).

Digital devices and virtual classroom

Bundoora Primary School follows the Department's [Cybersafety and Responsible Use of Technologies Policy](#) with respect to supervision of students using digital devices.

Students requiring additional supervision support

Sometimes students will require additional supervision, such as students with disability or other additional needs. In these cases, the Principal or delegate will ensure arrangements are made to roster additional staff as required. This may include on yard duty, in the classroom or during school activities.

Supervision of student in emergency operating environments

In emergency circumstances our school will follow our Emergency Management Plan, including with respect to supervision.

In the event of any mandatory period of remote or flexible learning our School will follow the operations guidance issued by the Department.

Bathroom supervision

Students moving around the yard during class time (eg. If on an errand to the office) must do so in pairs. This also applies to students requiring the use of the bathroom during class time.

COMMUNICATION

This policy will be communicated to our school community in the following ways:

- Included in staff induction processes
- Discussed at staff briefings or meetings, as required
- Included as a reference in our school newsletter each term
- Posted on compass each term
- Available in the school office in hard copy upon request
- Included on the School Website

Information for parents and students on supervision before and after school is available on our school website and parent reminders are sent at the beginning of each term in our school newsletter.

FURTHER INFORMATION AND RESOURCES

- the Department's Policy and Advisory Library (PAL):
 - [Child Safe Standards](#)
 - [Cybersafety and Responsible Use of Technologies](#)
 - [Duty of Care](#)
 - [Excursions](#)
 - [Supervision of Students](#)
 - [Visitors in Schools](#)

POLICY REVIEW AND APPROVAL

Policy last reviewed	August 2023
Approved by	Principal
Next scheduled review date	August 205

This policy will also be updated if significant changes are made to Bundoora Primary school grounds that require a revision of yard duty and supervision arrangements.